

Round flow cassette

FCQG-F



Optional Presence & floor Sensor



Home leave operation



Optional Auto-cleaning filter



Draught prevention



Individual flap control



Drain Pump Kit

INVERTER

ROUND FLOW



360° air discharge for optimum efficiency and comfort

› The round flow cassette provides a more comfortable environment and offers greater savings in energy consumption to shop, office and restaurant owners

› Lowest installation height in the market: 204mm for class 71

› Individual flap control: flexibility to suit every room layout without changing the location of the unit!

› Modern style decoration panel is available in 3 different variations: white (RAL9010) with grey louvers, full white (RAL9010) or auto cleaning panel

› Daily automatic filter cleaning results in higher efficiency & comfort and lower maintenance costs. 2 filters available: standard filter and finer mesh filter (for fine dust applications e.g. clothing shops)

FCQG-F

Auto cleaning cassette

More energy efficient and user-friendly than any other cassette

- › Running costs are reduced by 50% compared with standard solutions
- › Automatic filter cleaning.
- › Less time is required to maintain the filter: dust can be removed easily with a vacuum cleaner without opening the unit.

Finer mesh panel

- › For dust prone areas (i.e. clothing and book shops) a finer mesh panel (BYCQ140DGF) ensures consistent performance and optimum air distribution
- › Clean ceilings ensured thanks to fine mesh and clean filter

BYCQ140DG	BYCQ140DGF
Auto-cleaning panel	auto-cleaning panel with fine mesh filter
White with grey louvers	White with grey louvers

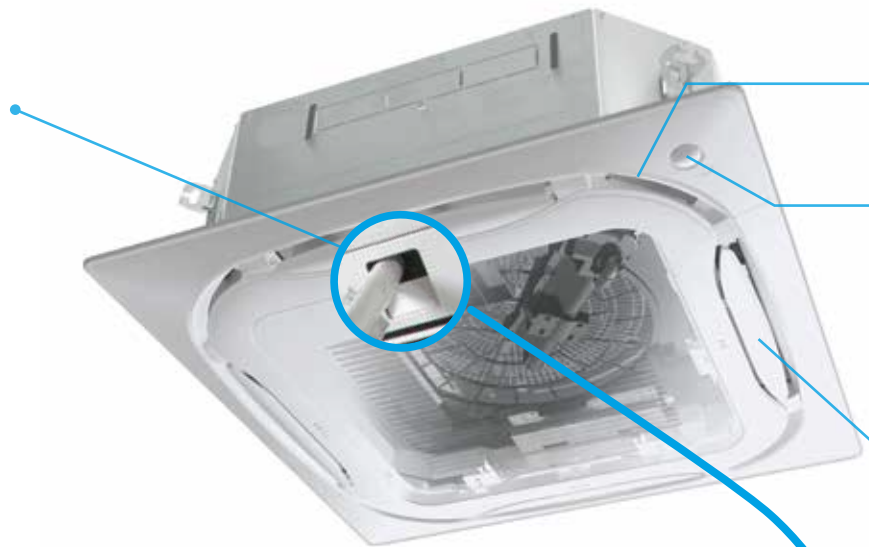

Dust can be removed easily with a vacuum cleaner without opening the unit.



Auto-cleaning cassette for maintaining the optimum store atmosphere



Air distribution with a clean filter



Air distribution with a dusty filter

References

Coral shop, UK

Running costs were reduced by up to 50% compared with standard solutions thanks to clean filter

Energy consumption (kWh)



Cumulative energy comparison over 12 months →

Why choose a round flow cassette?

- 360° air discharge for optimum comfort
- Intelligent sensors for maximum efficiency



360° air discharge for improved comfort

- › Industry-first and proven design.

Intelligent sensors improve efficiency and comfort even more

- › The presence sensor adjusts the set point if no one is detected in the room leading to up to 27% savings. It also automatically directs air flow away from any person to avoid draught.

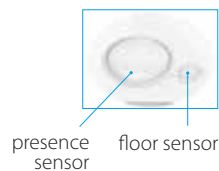

- › The infrared floor sensor detects the average floor temperature and ensures even temperature distribution between ceiling and floor to prevent cold feet.

Flexible installation

- › Flaps can be individually controlled or closed using the wired remote control, to suit room configuration. Optional closure kits are also available.

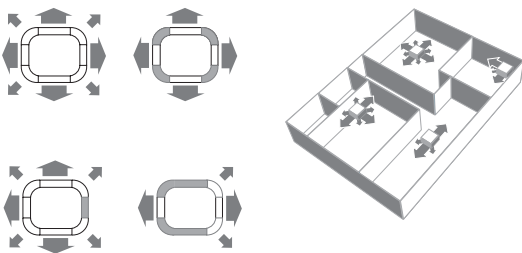

Benefits for the installer

- › Product with unique functions in this market.
- › Less time needed for onsite maintenance.
- › Use the controller to individually open or close any of the four flaps to easily adapt to a changing room layout.
- › Easy set-up of the sensor option to improve comfort and save energy.

Benefits for the consultant

- › Product with unique functions in this market.
- › Designed for use in all types and sizes of commercial offices and retail environments.
- › Ideal product for improving BREEAM score/EPBD in combination with Sky Air Seasonal Smart or VRV IV heat pump units.

Benefits for the end user

- › Designed for use in all types and sizes of commercial offices and retail environments.
- › Perfect environment conditions: no more draughts or cold feet.
- › Save up to 50% on running costs with the auto-cleaning panel, which also facilitates maintenance.
- › Your customers can save up to 27% on their energy bills thanks to the sensor option.
- › Flexible use of space thanks to individual flap control.

Indoor Model Name		FCQG35F	FCQG50F	FCQG60F	FCQG71F	FCQG100F	FCQG100F	FCQG125F	FCQG125F	FCQG140F	FCQG140F	
Outdoor Model Name		RXS35L3	RXS50L	RXS60L	RZQSG71L3V1	RZQSG100L9V1	RZQSG100L8Y1	RZQSG125L9V1	RZQSG125L8Y1	RZQSG140L9V1	RZQSG140L1Y1	
Cooling Capacity (Min. / Nom. / Max)	kBtu/hr	4.4/11.6/13.7	5.8/17.1/18.1	5.8/19.5/19.5	10.9/23.2/27.3	17/32.5/38.2		19.4/41/47.8		21.1/45.8/52.5		
	kW	1.3/3.4/4.0	1.7/5.0/5.3	1.7/5.7/5.7	3.2/6.8/8	5/9.5/11.2		5.7/12/14		6.2/13.4/15.4		
Heating Capacity (Min. / Nom. / Max)	kBtu/hr	4.4/14.3/17.8	5.8/20.5/20.5	5.8/23.9/23.9	25.612/25.6/30.7	17.4/36.5/43.7		20.5/46.1/54.6		21.1/52.9/61.4		
	kW	1.3/4.20/5.2	1.7/6.00/6.0	1.7/7.0/7.0	3.5/7.5/9	5.1/10.8/12.8		6/13.5/16		6.2/15.5/18		
Nominal Running Current at 220V (Cooling)	A	4.02	6.6	7.8	9.9	13.5	4.8	17.5	6.3	20.9	7.5	
Nominal Running Current at 220V (Heating)	A	5.4	7.6	9.3	9.7	14.3	5.1	18.6	6.7	21.3	7.7	
Seasonal efficiency (according to EN14825)	Energy label	A++						A		-	-	
	Pdesign	kW	3.50	5.00	5.70	6.80	9.50		12.00		-	-
	SEER		6.35	6.48	6.22	6.10	6.50		5.30		-	-
Cooling	Annual energy consumption	kWh	193	270	321	390	512		793		-	-
	Energy label	A++			A+					-	-	
Seasonal efficiency (according to EN14825)	Pdesign	kW	3.32	4.36	4.71	6.33	7.60		8.03		-	-
	SCOP		4.90	4.29	4.00	4.10	4.10		4.01		-	-
	Annual energy consumption	kWh	949	1,426	1,646	2,162	2,596		2,804		-	-
Nominal efficiency	Nominal EER		3.74	3.55	3.48	3.21	3.3		3.21		3.01	
	Nominal COP		3.50	3.70	3.52	3.61	3.54		3.41			
Indoor	Panel Model and Color		BYCQ140D7W1 / Pure White (RAL 9010) with grey louvers									
			BYCQ140D7W1W / Pure White (RAL 9010)									
			BYCQ140D7GW1 / Pure White (RAL 9010) / Auto Cleaning Panel									
	Panel Dimensions HxWxD	mm	50x950x950									
	Panel Net Weight	kg	5.40									
	Power Supply	Ph/Hz/V	1~/50/220-240									
	Air Flow (Nom)	CFM	374	378	395	427	621		678			
	Sound Pressure Level (High/Nom./Low)	dBA	31/29/27			33/31/28		37/33/29		41/35/29		
	Dimension (HxWxD)	mm	204x840x840				246x840x840					
	Net Weight	kg	18	19		21		24				
Outdoor	Power Supply	Ph/Hz/V	1~/50/220-240				3N~/50/380-415	1~/50/20-240	3N~/50/380-415	1~/50/220-240	3N~/50/380-415	
	Sound Pressure Level	dBA	48		49		53		54		53	
	Dimension (HxWxD)	mm	550x765x285	735x825x300		770 x900x320	990 x940x320				1,430 x940x320	
	Net Weight	kg	34	47	48	67	72	82	74	82	95	101
	Operation range - Cooling Ambient Min.~Max.	°CDB	-10~46				-15.0~46					
	Operation range - Heating Ambient Min.~Max.	°CWB	-15~18				-15~15.5					
	Pipe Connection Liquid	in	1/4				3/8					
	Pipe Connection Gas	in	3/8	1/2		5/8						
	Max. Piping Length	m	20	30		50						
	Max. Elevation	m	15	20		15	30					
	Compressor Type	Hermetical Sealed Swing compressor										
	Refrigerant Type - GWP	R-410A/2,087.5										
	Refrigerant Charge - Eq. CO ₂ Emissions	kg/TCO ₂ eq	1.2/2.5	1.7/3.5	1.5/3.1	2.75/5.7	2.9/6.1				4.0/8.4	

Daikin Europe N.V. Naamloze Vennootschap · Zandvoordestraat 300 · 8400 Oostende · Belgium · www.daikin.eu · BE 0412 120 336 · RPR Oostende (Responsible Editor)

The present leaflet is drawn up by way of information only and does not constitute an offer binding upon Daikin Europe N.V. Daikin Europe N.V. has compiled the content of this leaflet to the best of its knowledge. No express or implied warranty is given for the completeness, accuracy, reliability or fitness for particular purpose of its content and the products and services presented therein. Specifications are subject to change without prior notice. Daikin Europe N.V. explicitly rejects any liability for any direct or indirect damage, in the broadest sense, arising from or related to the use and/or interpretation of this leaflet. All content is copyrighted by Daikin Europe N.V.



Daikin Europe N.V. participates in the Eurovent Certification programme for Liquid Chilling Packages (LCP), Air Handling Units (AHU), Fan Coil Units (FCU) and Variable Refrigerant Flow systems (VRF) Check ongoing validity of certificate online: www.eurovent-certification.com or using: www.certiflash.com



DMEA 17-135